



SHELTER DOME



## MODULAR BATHROOM - GLITZCAMP

READY-TO-ASSEMBLY

SYSTEMS FOR GLAMPING FACILITIES

REDEFINE WET ROOMS IN GLAMPING BUSINESS

# MODULAR BATHROOM

Modular bathrooms are revolutionizing the glamping industry by redefining the guest experience. Specifically designed for dwelling dome wet rooms, they offer numerous benefits such as fast build-up, elegant design, and precise modular construction. In this presentation, we will explore the key benefits of the modular bathroom for glamping businesses and how it enhances the overall guest experience.

The first major advantage of the modular bathroom is its fast build-up. Unlike traditional construction, modular bathrooms are Self-Contained and can be built in a fraction of the time. This allows glamping businesses to quickly and efficiently add new units to their properties without disrupting their guests' experience. The modular bathroom's ease of installation also saves time and money on labor and construction costs.

Elegant design. The sleek, modern design of the bathroom adds an element of sophistication to the glamping experience. It also provides a luxurious and comfortable feel for guests, helping them to relax and enjoy their stay. The modular bathroom's design is also customizable, allowing businesses to choose from a variety of styles, colors, and materials to fit their specific brand and aesthetic.

Own-developed Sealing Design like no other. It's precise modular construction. Each connection is built with exact measurements, ensuring a perfect fit and finish. This precision makes the modular bathroom an excellent choice for full-sealing and solid free-standing.

The modular bathroom enhances the glamping experience by providing guests with comfort and convenience. With all the necessary amenities in one place, guests can easily access the bathroom without leaving their dwelling dome. The bathroom's sustainable design also reduces environmental impact, making it an eco-friendly option for businesses looking to minimize their carbon footprint. Finally, the modular bathroom's modern and sleek design adds to the overall aesthetic of the property, providing a visually appealing experience for guests.

In conclusion, the modular bathroom is an excellent investment for glamping businesses looking to enhance the guest experience. With its fast build-up, elegant design, and precise modular construction, it provides numerous benefits that set it apart from traditional construction methods. By incorporating modular bathrooms into their properties, glamping businesses can offer a unique and luxurious experience that guests will remember for years to come.



# MODULAR BATHROOM

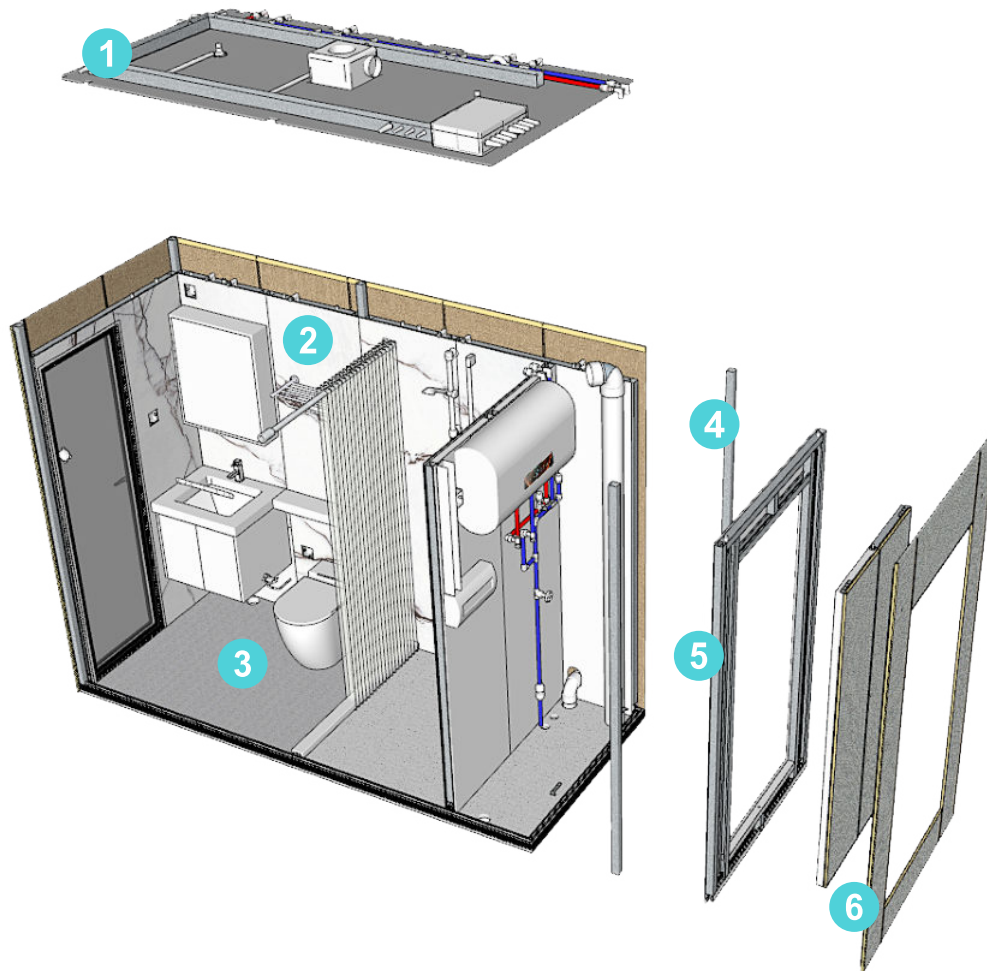

1. Ceiling composed of A zinc-aluminum honeycomb panel with its own load-bearing structure and insulation, and all circuits, waterways, and exhaust are integrated.

2. Internal cladding with ceramic tiles

3. GRC Concrete base

4. Structure Columns

5. Structure with metal profiles: studs and/or channels

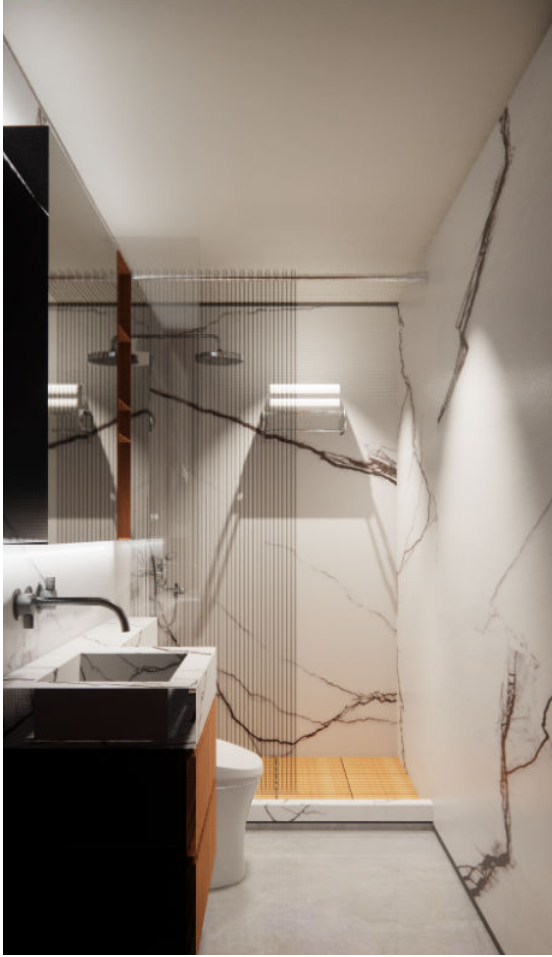

## KEY BENEFITS

### 1/WIDE SELECTION

Complete range of shells solution

### 2/INNOVATIVE SOLUTION

Experience from Glamping business, Unique dry wet separation system

### 3/ FLEXIBILITY

Complete design flexibility  
Engineered site installation  
solutions available

### 4/ SIMPLICITY OF REALIZATION

Complete design flexibility  
Engineered site installation  
solutions available  
Fast build-up and connection

### 5/ TIMES OPTIMIZATION

Reduction of on-site labor, Reduced the building program

### 6/ ELIMINATION IN THE GLAMPING INDUSTRY

In-depth understanding of the industry end-users,  
listening to the real needs of the market,  
comprehensive and proactive coordination of the supply chain,  
professional design,  
and construction with complete qualifications



# MODULAR INSTALLATION PROCESS

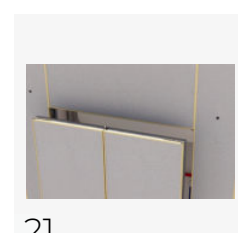
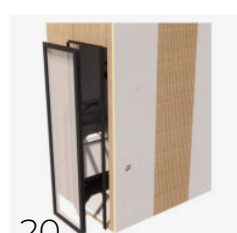
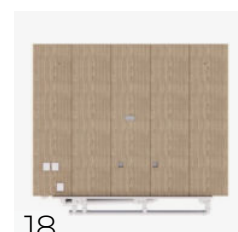
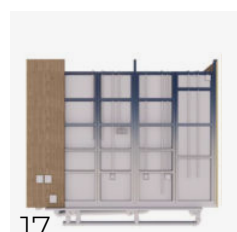
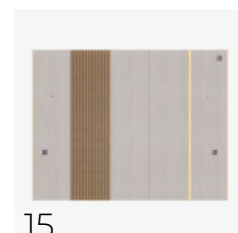
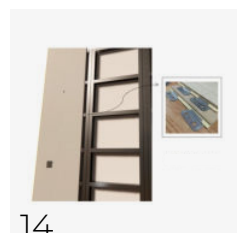
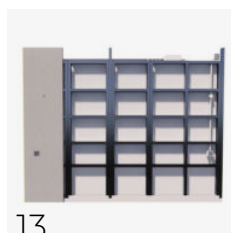
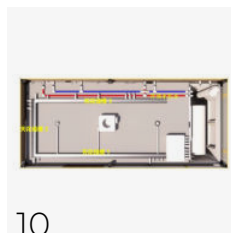
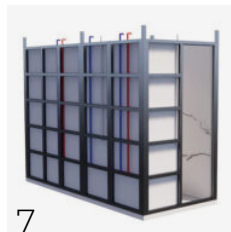

# CONFIGURATION

- **TOILET DOOR**

Size: 2100 \* 600  
Aluminum alloy frosted black glass

- **ELEVATING SHOWER FAUCET**

Bright color dual function  
material: faucet main body copper lifting shower stainless steel pipe top spray handheld plastic

- **COLD AND HOT WATER TAP**

Material: Copper

- **PULSE TOILET**

Size: 665 \* 395 \* 430  
Ground drainage hole spacing 300MM  
Feet sensation flush sailor press flush

- **TISSUE BOX**

304 stainless steel bright light

- **TOILET BRUSH**

304 stainless steel bright light

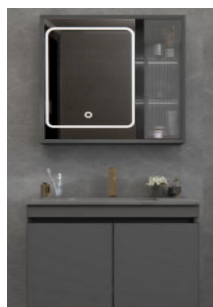

- **STAINLESS STEEL BATHROOM CABINET**

Main cabinet: stainless steel  
Mirror cabinet: aluminum alloy right side illuminated  
Table top: gray rock slab  
Size: 600 \* 480

- **HEATER**

Size: 767 \* 493 \* 263

- **TOWEL RACK**

S304 stainless steel bright light

- **CLOTHES HOOK**

S304 stainless steel bright light

- **STORAGE RACK**

S304 stainless steel bright light

- **FLOOR DRAIN**

304 stainless steel wire drawing  
Size: 100 \* 100



## WARNING:

This product must be installed and serviced by professional service technicians. Even though we do our best to provide a product compliant with regulations of each country, it is still possible that some specific installation requirements must be adjusted by local professional technicians.

# GET IN TOUCH

## Head Office & Showroom

Guangzhou, China

+86 139 2885 8552

admin@shelter-structures.com

shelter-dome.com

shelterdomos.com - Español

## Join the SHELTER DOME NETWORK

We are actively seeking opportunities to collaborate with global partners and empower business like yours to support the growth of the local glamping industry.



Customized Accommodation, Event & Exhibition,  
Green House & Off-grid Solution...beyond your imagination